



Board of Aldermen Request for Action

MEETING DATE: 4/1/2025

DEPARTMENT: Public Works

AGENDA ITEM: Resolution 1457, Facilities Extension Agreement with Evergy

REQUESTED BOARD ACTION:

A motion to approve Resolution 1457, authorizing the Mayor to sign a Facilities Extension Agreement with Evergy and authorizing the expenditure of \$106,459.64 for the extension of electric service.

SUMMARY:

The new pump station at 144th Street will require three phase electric service. Currently the electric service in this area is single phase electric service. Evergy will need to remove the single-phase circuit and replace it with a new three phase line from Highway 169 to the pump station site.

Extending utilities to a site is typically paid by the owner. This cost was not included as part of the bid for the construction of the 144th Street Pump Station project. The cost to complete this work is \$106,459.64.

PREVIOUS ACTION:

This expense is included in the reimbursement Resolution 1455 for financing.

POLICY ISSUE:

Infrastructure Maintenance / Capacity and development

FINANCIAL CONSIDERATIONS:

Project Costs:

Epic Concrete Construction	\$4,799,650.00
Force Account	\$ 200,000.00
Evergy	<u>\$ 106,459.64</u>
Total	\$5,106,109.64

Funding:

2025 CWWS CIP	\$2,300,000.00
Corps Funding	<u>\$1,500,000.00</u>
Total	\$3,800,000.00

The balance of \$1,306,109.64 will be funded through the COP proceeds.

A reimbursement Resolution 1455 for financing is also on the agenda for Board action.

ATTACHMENTS:

- | | |
|--|-----------------------------------|
| <input type="checkbox"/> Ordinance | <input type="checkbox"/> Contract |
| <input checked="" type="checkbox"/> Resolution | <input type="checkbox"/> Plans |
| <input type="checkbox"/> Staff Report | <input type="checkbox"/> Minutes |
| <input checked="" type="checkbox"/> Other: Map Agreement | |

RESOLUTION 1457

A RESOLUTION AUTHORIZING THE MAYOR TO SIGN A FACILITIES EXTENSION AGREEMENT WITH EVERGY AND AUTHORIZING THE EXPENDITURE OF \$106,459.64 FOR THE EXTENSION OF ELECTRIC SERVICE

WHEREAS, the City is constructing a regional sanitary sewer pump station, on 144th Street; and

WHEREAS, Evergy will need to extend three phase electric service to the pump station site; and

WHEREAS, Evergy has provided a Facilities Extension Agreement providing the cost of the project to the City of \$106,459.64.

NOW, THEREFORE, BE IT RESOLVED BY THE BOARD OF ALDERMEN OF THE CITY OF SMITHVILLE, MISSOURI:

THAT the Mayor is hereby authorized to sign the Facilities Extension Agreement with Evergy and the payment of \$106,459.64 to extend three phase electric service is approved.

PASSED AND ADOPTED by the Board of Aldermen and **APPROVED** by the Mayor of the City of Smithville, Missouri, this 1st day of April, 2025.

Damien Boley, Mayor

ATTEST:

Linda Drummond, City Clerk

**Facilities Extension Agreement**

Work Request No. M108146270

Project No. Quote No. 1

Date: February 24, 2025

Customer Information

Principal Contact: <u>CHARLES SOULES, DIRECTOR OF PW</u>		Customer Type: <u>Commercial/Industrial</u>	
Customer Name: <u>CITY OF SMITHVILLE</u>			
Address: <u>107 W MAIN</u>	State: <u>MO</u>	Zip: <u>64089</u>	City: <u>SMITHVILLE</u>
Phone #: <u>816-532-3897</u>	Mobile #: <u>816-985-8369</u>	Email Address: <u>CSOULES@SMITHVILLE.ORG</u>	
Location of Work: <u>540 NE 144TH ST SMITHVILLE MO. 64089</u>		S/T/R: <u>35/53N/33W</u>	
Project Name: <u>REPLACE SINGLE PHASE LINE WITH 3 PHASE LINE TO NEW WATE WATER PUMP STATION</u>			
Scope of Work:			
Terms of Payment: <u>Select</u>		Job Type: <u>Select</u>	

Facilities Extension Agreement

THIS AGREEMENT, made and entered into by and between Evergy, hereinafter called "Company", and CITY OF SMITHVILLE, hereinafter called "Customer".

WITNESSETH:

That in consideration of the mutual covenants and agreements herein contained, the parties hereto agree as follows:

1. Company, for and in consideration by Customer as described below, does hereby covenant and agree to furnish electric facilities, as defined by Company's electric distribution extension policy, to Customer at the location(s) described above:
2. Customer, for and in consideration of the construction work to be done by the Company in order to furnish such service, agrees to make the following considerations prior to Company starting construction: ☐ Yes ☐ N/A

a) Non-Refundable Construction Charge (Contribution) @ \$ 106,459.64

b) Potentially Refundable Construction Charge (Advance) @ \$0.00

Method of Payment for Contribution and Advance: Check

3. The Non-Refundable Construction Charge is based upon construction estimates. Where the Charge is considered highly uncertain, a comparison of estimated to actual costs will be made at extension completion, at Company's discretion, if noted here: ☐ Yes ☐ No ☐ N/A
4. Classification of Service by Company: ☒ Permanent ☐ Indeterminate
5. Company's Construction Charges requirements, as calculated for this Extension Agreement, may become void after 120 days, at Company's discretion, after Agreement is presented to Customer, unless Agreement is fully executed before that time, indicated by signature and date below.
6. Customer is responsible for providing special ditching required for soil conditions including, but not limited to the presence of rock or other environmental issues which prevents the use of normal trenching and backfilling practices used in trenchable soil. Customer is responsible for maintaining grade and clearance during Company's construction. Customer is responsible for adhering to all requirements set forth in the Electric Extension Standards.
7. All customer installed conduit and pads must be surveyed by a licensed, certified survey company before the project will be released by EVERGY for construction, if noted here: ☐ Yes ☐ No ☐ N/A
8. All necessary easements granting EVERGY permission to install equipment on private property must be signed, notarized and returned to EVERGY prior to the project being released for construction. Easements are required from the customer or other property owners, if noted here: ☐ Yes ☐ No ☐ N/A

Upon receipt of a fully executed original copy of this Extension Agreement and the applicable considerations for Construction Charges received, Company will finalize the design. EVERGY will schedule construction for the specified property(ies) above once customer required work has received required approvals. IN WITNESS WHEREOF, the parties hereto have affixed their signatures as dated below:

CITY OF SMITHVILLEDAMIEN BOLEY, MAYOR

Customer Name - Printed

Customer Signature

Date of Signature: 4/1/2025JOHN MASSIE

Company Representative - Printed

Company Signature

Date of Signature: 03/04/25**Evergy Accounting Distribution to be Credited (FOR INTERNAL EVERGY USE ONLY):**

WR #	Account	Op Unit	Dept*	Project*	Resource	Description	Amount
\$M10814627	107000	20109	287	0	3405	Construction Charges - Installation	\$ 69,605.08
\$M10814627	107000	20109	287	GM-45400	3405	Install Padmount Transformer	\$ -
\$M10814627	107000	20109	287	GM-45200	3405	Install Polemount Transformer	\$ -
\$M10814627	108000	20109	287	0	3410	Construction Charges - Removal	\$ 29,198.00
\$M10814627	XXXXXX	20109	287	0	XXXX	Other	\$ -
\$M10814627	253112	20109	287	0	3405	Gross Up	\$ 7,656.56
*Fields required for Accounting							\$ 106,459.64

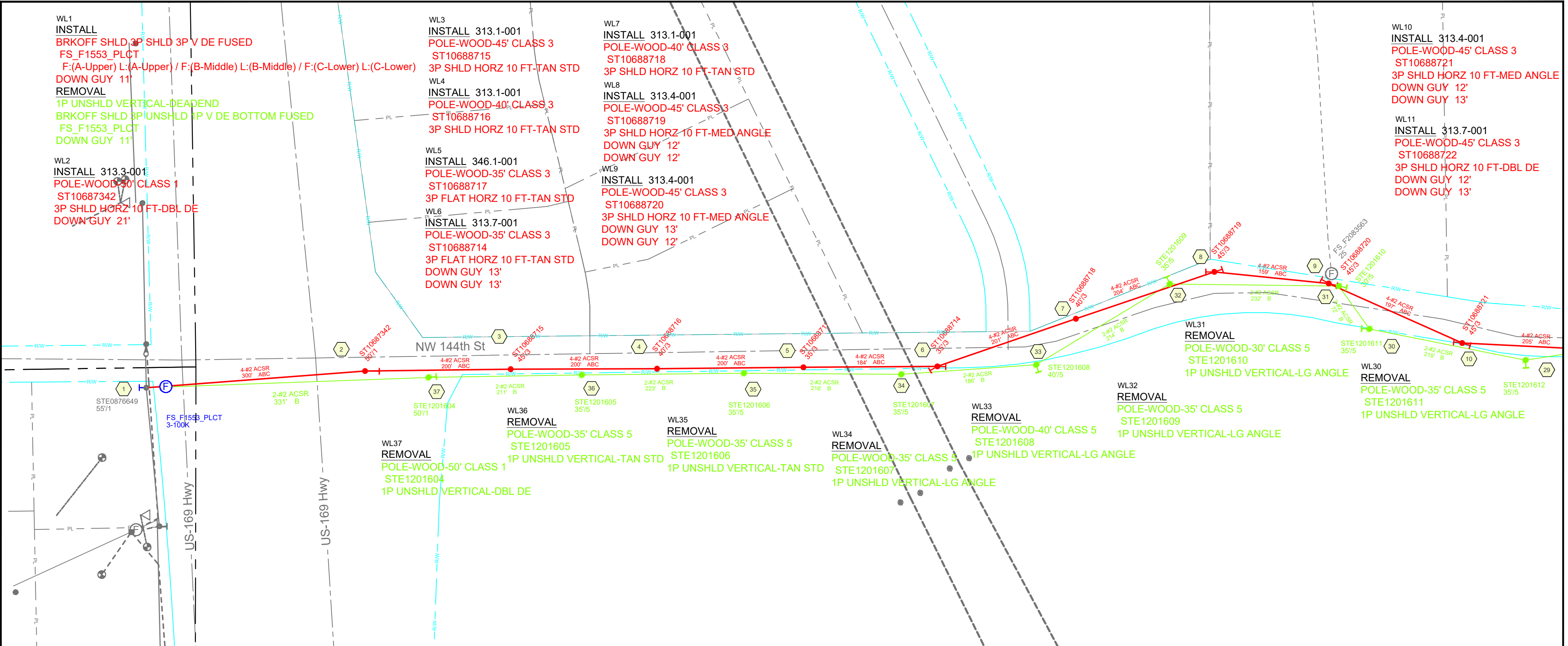

UPSTREAM PROTECTIVE DEVICE BR_0355013022

DISCLAIMER AND COPYRIGHT NOTICE

The information contained on this drawing/map is used to locate, identify and/or inventory Evergy Inc. electrical facilities located on parcels of land in the Evergy Inc. service area. It is intended for reference purposes only and is NOT to be construed or used as a "legal description." Map information is believed to be accurate but accuracy is not guaranteed. This information should not be relied upon as a substitute for an actual field survey. This drawing/map is not to be used as a substitute for using the ONE-CALL system for purposes of digging and excavation. You must call ONE-CALL (811) to notify operators of underground facilities of proposed excavation or digging to request that member companies mark their underground facilities before they dig. In no event will Evergy Inc. be liable for any damages, including loss of data, lost profits, business interruption, loss of business information or other pecuniary loss that might arise from the inaccuracy, use or misuse of this map or the information it contains. You are prohibited from reproducing or distributing this drawing/map or any portion of it without written permission of Evergy Inc. © Evergy Inc. All rights reserved.

SCALE

0 100

N

EXISTING -----

INSTALL - - - - -

REMOVE - - - - -

MODIFY - - - - -

811

Know what's below.
Call before you dig.

CONTACTS

PROJECT DESIGNER: JOHN (816) 766-3997

PHONE #: (816) 766-3997

CUSTOMER: CITY OF SMITHVILLE

PHONE #: ---

TITLE CITY OF SMITHVILLE

SANITARY SEWER PUMP STATION

ADDRESS 400 NE 144TH ST

CITY SMITHVILLE STATE MO

13.8 KV DATE 2/24/2025

WO# M108146270

CENTER NORTHLAND

CIRCUIT 0355013022

DESIGNED BY JMASSIE

SHEET 1 OF 2

BUILT AS DESIGNED

CHANGES AS NOTED

LEADMAN

SCM

DATE

DATE

REV. DATE BY CHECKED APPROVED

evergy

Think Safety!

DWG FILE # M108146270-1

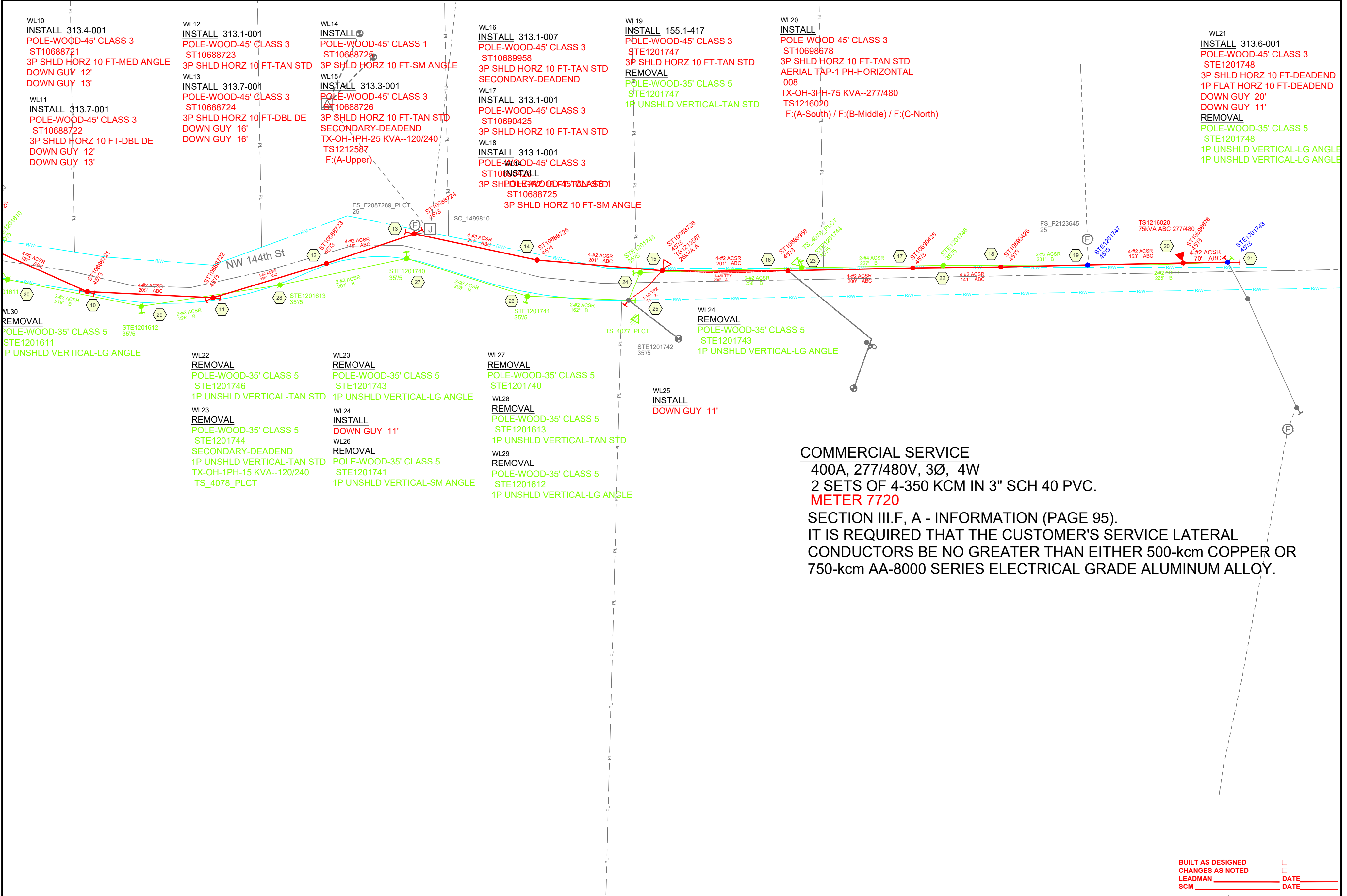

DISCLAIMER AND COPYRIGHT NOTICE
The information contained on this drawing/map is used to locate, identify and/or inventory Evergy Inc. electrical facilities located on parcels of land in the Evergy Inc. service area. It is intended for reference purposes only and is NOT to be construed or used as a "legal description." Map information is believed to be accurate but accuracy is not guaranteed. This information should not be relied upon as a substitute for an actual field survey. This drawing/map is not to be used as a substitute for using the ONE-CALL system for purposes of digging and excavation. You must call ONE-CALL (811) to notify operators of underground facilities of proposed excavation or digging to request that member companies mark their underground facilities before they dig. In no event will Evergy Inc. be liable for any damages, including loss of data, lost profits, business interruption, loss of business information or other pecuniary loss that might arise from the inaccuracy, use or misuse of this map or the information it contains. You are prohibited from reproducing or distributing this drawing/map or any portion of it without written permission of Evergy Inc. © Evergy Inc. All rights reserved.

EXISTING -----
INSTALL - - - - -
REMOVE - - - - -
MODIFY - - - - -



CONTACTS
PROJECT DESIGNER: JOHN (816) 766-3997
PHONE #:
CUSTOMER: CITY OF SMITHVILLE
PHONE #:

TITLE CITY OF SMITHVILLE
SANITARY SEWER PUMP STATION
ADDRESS 400 NE 144TH ST
CITY SMITHVILLE STATE MO
13.8 KV DATE 2/24/2025

WO# M108146270
CENTER NORTHLAND
CIRCUIT 0355013022
DESIGNED BY JMASSIE
SHEET 2 OF 2

DWG FILE # M108146270-1

BUILT AS DESIGNED
CHANGES AS NOTED
LEADMAN
SCM

REV. DATE BY CHECKED APPROVED



Think Safety!